



L'ARTISAN 96  
Stylish Stainless-steel Cabinetry

*Ideal kitchen and bathroom, L'Artisan 96 made with German craftsmanship, durable for 50 years*



We promises that every plate is made of 304stainless steel  
L'Artisan 96 five star stainless steel Comparative Manual of strengths



German DE technology,  
China CN manufacturing



## ABOUT L' ARTISAN 96

L'Artisan 96 is an international brand specializing in stainless steel modular furnishing. With headquarters in Singapore, L'Artisan 96 was borne out of the passion to create products stamped with a distinctive standard of quality and design to captivate the discerning homeowner.

The heart of the home is the kitchen. As intimate as the bedroom, this is where stories, laughter and sumptuous meals are prepared and shared. Understanding the need for a kitchen that is both practical and visually appealing, L'Artisan 96 proudly introduces L'Artisan 96 **"Kitchen To Inspire"** - a range of functional, durable and efficient modular kitchens, exquisitely crafted using the latest technology and innovate materials to create spaces of ultimate comfort and indulgence.

Integrating modern aesthetics with efficient layouts and equipped with top of the line appliances, fittings and fixtures, L'Artisan 96 **"Kitchen To Inspire"** combine the durability of stainless steel with the versatility derived from a patented ion-plating process, creating cabinetry and surfaces in a variety of finishes such as rich wood and luxurious leather textures, magically transforming an otherwise industrial-looking space into the kitchen of your dreams.

Whether it's a small apartment or an opulent open-concept kitchen, classic, traditional, contemporary or modern – there is a L'Artisan 96 **"Kitchen To Inspire"** for your unique style.



# About Our Factory

Our factory MJ is a modern scientific and technological kitchen and bathroom product manufacturer integrating R&D, design, production, sales and service. We takes the global market as the strategic goal, and recruits professional design and production personnel in the industry, specializing in the production of high-quality stainless steel bathroom cabinets, integrated cabinets, faucet hardware and other products The company's production line mainly introduces the most advanced stainless steel grooving machine and the most advanced imported optical fiber laser cutting equipment in the market at present. The first phase of the company covers an area of 30 mu and has a standard workshop of 20000 square meters Production process automation, information,, two pronged approach,, to ensure that the product from the design, cutting, grooving, bending, assembly of each link are the best to the most ideal, high-end products

**Servants**

**30+**

Research &  
Development staff

**Experience**

**50+**

Production process

**Land area**

**20000+**

Square meter



# PROJECT

Our stainless steel cabinets successfully won the bid for the Togo government in Africa, the presidential palace project.

The Republic of Togo, referred to as Togo for short, is one of the West African countries, bordered by Benin to the east, Burkina Faso to the north, Ghana to the west, and a short coastline to the south facing the Gulf of Guinea. Togo's Presidential Palace was built with the aid of my country with a construction area of 6,343 square meters and an investment of about 8.3 million.



# MALAYSIA





# SINGAPORE





# JAKARTA

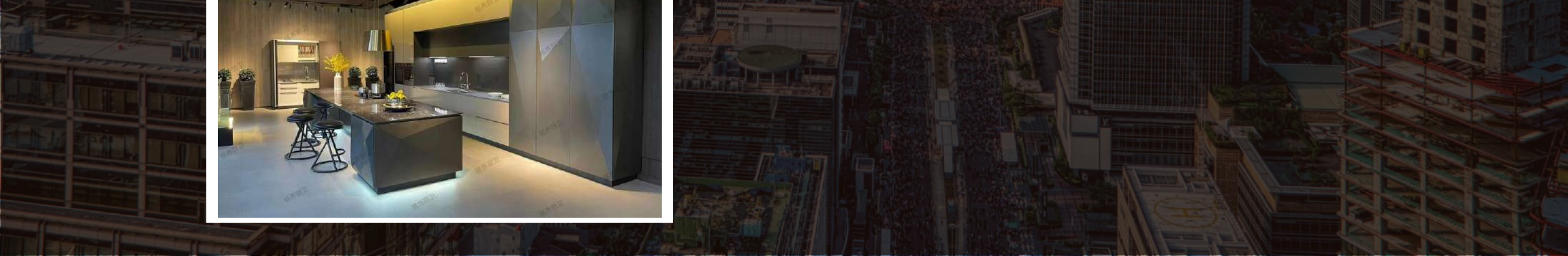



# TAIWAN





## R&D strength

MJ has established a strong R&D team to provide continuous innovation support for the product system, allowing stainless steel kitchen cabinet products to keep up with market demand and lead the industry.

## Core patents

The number of patents obtained every year has doubled exponentially, and the strength of intellectual property rights has grown rapidly;



## Core craftsmanship

Door panel: The exterior surface adopts baking paint technology. The texture elements are unique and beautiful. It is comfortable to touch, safe and non-toxic. It is environmentally friendly and healthy, and is corrosion-resistant and scratch-resistant. There are many styles to choose from.

Countertop: Made of 304 food-grade stainless steel, double-sided coating, easy to care for, with various patterns to choose from; the water-blocking back of the countertop is integrally formed to prevent any leakage or water seepage.



# PRODUCT SERIES



Kitchencabinet



Wardrobe



Winecooler



Bathroomcabinet

Our high-end stainless steel overall kitchen cabinets include : stainless steel kitchen cabinets, stainless steel wardrobes, stainless steel wine cabinets, stainless steel Bathroom cabinets and 8 mainstream styles such as modern, simple European, light luxury. Nordic, and new Chinese style and hundreds of more Colors and textures are available for the moment, allowing consumers to have more choices.



# 16 BIG CORE TECHNOLOGY

The stainless kitchen cabinet made in all steel without one piece of wood board suit for our family much better



10mm Scratch-resistant  
countertops



1 mm Scratch-resistant  
countertops



One-piece  
moulding process



Hexagonal  
Diamond Cut



Modelling Process



Waterproofing



Rounded corner  
design



Precise positioning  
design



Arc door panel



Simple handle-free  
design



Food grade  
304 material



Durable and  
no deformation



Green products



Anti-ant  
technology



Alkali Carbonate



Fire protection  
technology



# 01 FULL CONTAINER PACKAGING

# 22

22 MAJOR PRODUCT ADVANTAGES



## PRECISION HOLE ARRANGEMENT IS SMOOTH AND DURABLE

The precise hole arrangement is tight and firm, making your cabinet durable

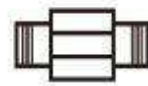

## ONE-PIECE MOULDING HIGH PRECISION STANDARDS

The cabinet is molded by Lartisan96 original factory which is more stable and smooth, making your cabinets precise and smooth.



## PRE-ASSEMBLY INSPECTION OF ORIGINAL QUALITY

Strict selection based on unified standards of automated technology to make your cabinets flawless inside and out

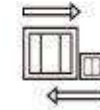

## FULL CONTAINER DELIVERY ENTERING THE HOUSE FLAWLESSLY

The perfectly formed cabinets will be delivered to your home intact, so that your cabinets will be of the same quality.

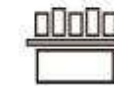

## WHOLE CABINET INSTALLATION IS TIME SAVING AND ENVIRONMENTALLY FRIENDLY

It shortens on-site construction time, effectively avoids garbage and dust generated during The installation process, and is more environmentally friendly.



01



02



03



04



05



06



07



08



## 02 SEAMLESS DRAWER

1. Our patented technology product is made of 0.12MM stainless steel plate, and the left and right side panels are integrally bent to form a seamless drawer.
2. Clean the drawers without leaving any dead space to prevent the growth of bacteria
3. When cleaning, just wipe it gently with a rag and there will be nowhere to hide the garbage.
4. Hidden Blum guide rails can bear a load of up to 60 kilograms and have built-in damping and silent effects.



**22** | 22 MAJOR PRODUCT  
ADVANTAGES



# 22

22 MAJOR PRODUCT  
ADVANTAGES

## 05 IMPORTED POWDER 阿克苏诺贝尔进口粉末

1. The world's largest paint group, the parent company of "Dulux" and "Laiwei Paint "
2. Imported outdoor metal powder paint with a service life of up to 50 years
3. The use of imported coatings can effectively prevent high temperatures and fire, thus ensuring personal safety and reducing property losses.

Note: To test the quality of the paint surface, you can take a color card sample and fold it in half to see if the paint is chipped or broken.







## 22 | 22 MAJOR PRODUCT ADVANTAGES

### 08 BREATHABLE HOLES 门板均有透气孔

1. Our stainless steel kitchen cabinets, sink cabinets and gas bottle cabinets all have ventilation holes (free as standard)
2. Nowadays, every household must have ventilation holes, otherwise the natural gas company will not turn on the gas. This is the practice in the market.
3. Anti-mold and anti-bacteria, prevent moisture and odor from being discharged, causing the cabinet to get damp.
4. Prevent pests, cockroaches and other pests



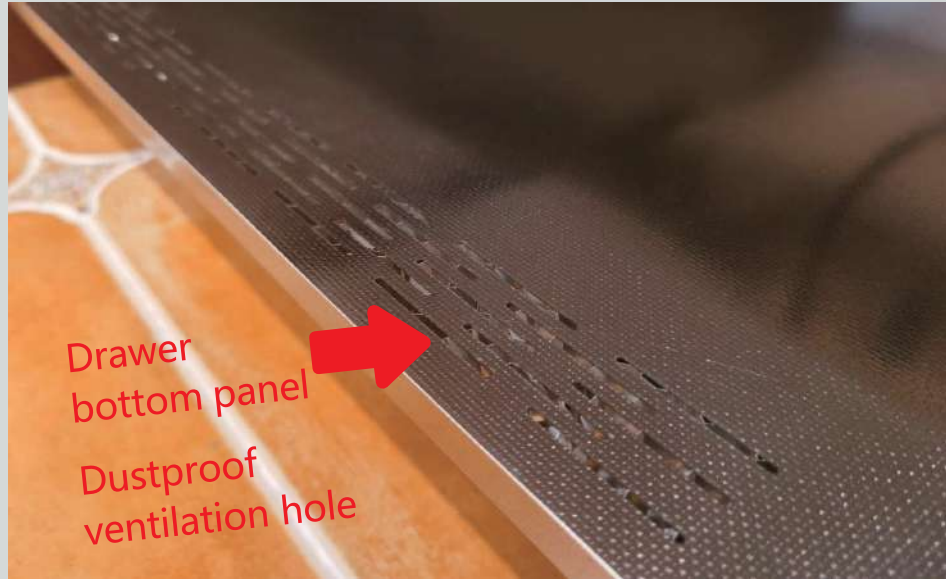

## 22 | 22 MAJOR PRODUCT ADVANTAGES

### 09 BREATHABLE HOLES 抽屉底板防尘透气孔

1. Each set of cabinets, electrical high cabinets, electrical base cabinets, drawer cabinets, and gas stove base cabinets come standard with ventilation holes.
2. The cabinet is easy to breathe and does not allow small particles to enter. Even in the moldy rain season, there will be no mold inside the cabinet.
3. Anti-mildew and anti-bacteria, prevent moisture and odor from being discharged, causing the cabinet to
4. Prevent pests, cockroaches and other pests



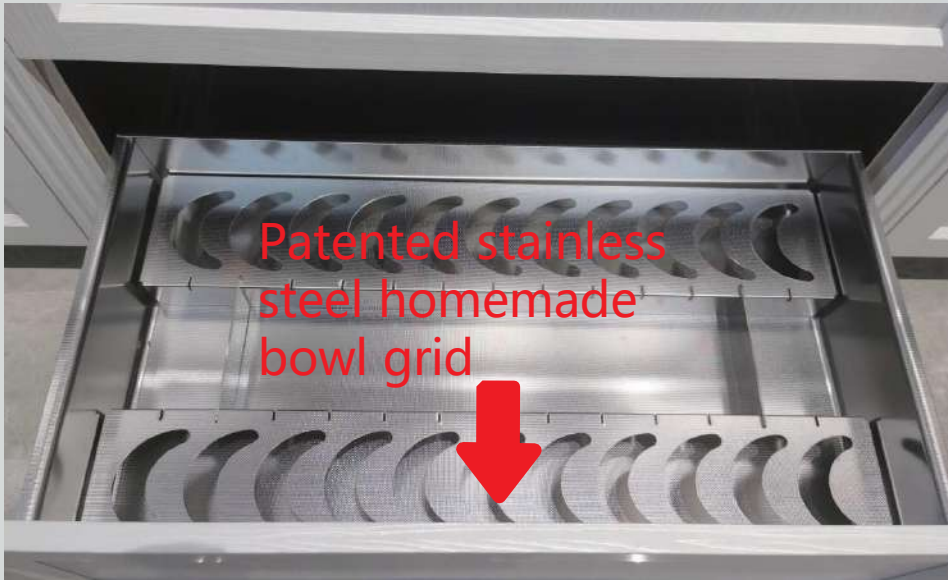

## 22 | 22 MAJOR PRODUCT ADVANTAGES

### 11 BOWL GRID BASKET 专利不锈钢自制碗格

1. MJ stainless steel kitchen cabinets, self-made patented stainless steel bowl grid blue
2. Bowl grid discharge is more scientific and space utilization is better
3. All made of 304 stainless steel with thickness up to 12MM
4. Using imported laser machine, the opening is smooth and does not hurt your hands
5. Manufacturer's patented production and more favorable prices

# 22

22 MAJOR PRODUCT  
ADVANTAGES

## 12 BASEBOARD 同色可拆卸踢脚线

1. Stainless steel skirting can perfectly block sewage and will not be corroded.
2. The paint baseboards in the same color as the cabinets are more beautiful
3. The baseboard thickness is up to 1.6CM, which is not only waterproof, moisture-proof, mold-free, and rust-free, but also less likely to deform during use.
4. Our stainless steel skirting adopts a breathable type with a reserved 0.5CM space, which is easy to install and helps dissipate odors during use.







## 22 | 22 MAJOR PRODUCT ADVANTAGES

### 15 DOOR PANEL 拆卸快装门板

1. The cabinet adopts Blum second-generation quick-release built-in integrated damping hinges imported from Austria. It has a warranty of 200,000 times and has a service life of up to 54.8 years after anti-fatigue testing.
2. The sink cabinet uses German Häfele SUS304 food-grade stainless steel hinges to ensure that it will not corrode or rust when the sink cabinet is exposed to long-term moisture.
3. The color and style of the door panel can be removed and replaced at any time during use.

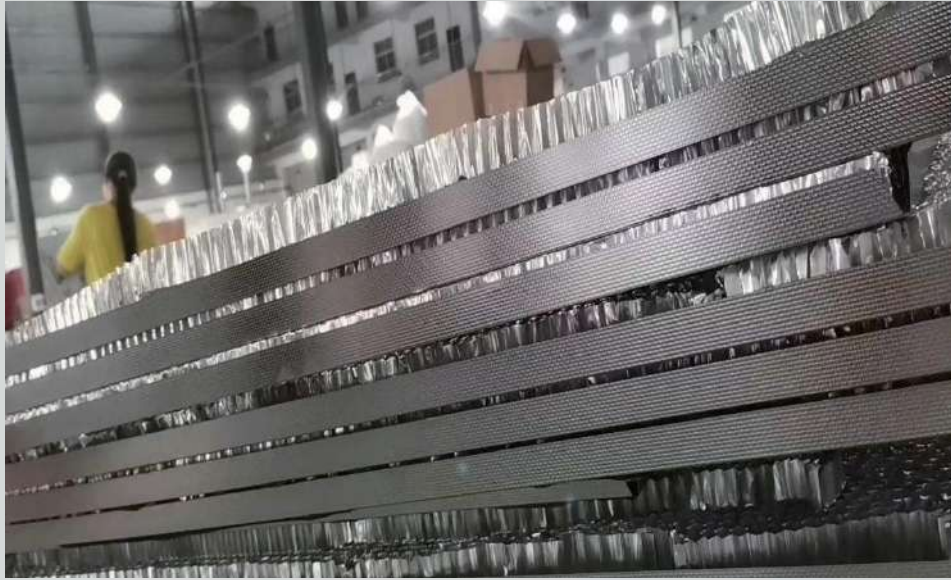

# 22

22 MAJOR PRODUCT  
ADVANTAGES

## 17 HONEYCOMB BOARD 台面填充航空蜂窝铝板

### Advantages of aviation honeycomb aluminum

1. Green, environmentally friendly and energy-saving materials: Aluminum honeycomb is an all-aluminum structure. It is a new building material that is green, environmentally friendly and energy-saving. It is known as the best building material in the 21st century.
2. It has light specific gravity, high strength, high stiffness, stable structure and is not easy to deform and has good flatness. Even if the aluminum honeycomb is large in size, it can achieve extremely high flatness. °
3. Outstanding sound insulation, heat insulation, fire prevention, and shockproof functions: Because the aluminum honeycomb core in the aluminum honeycomb is divided into many open cells, the flow of air and heat are easier to circulate.
4. Moisture-proof: Because the hollow aluminum honeycomb core made of equilateral hexagonal shape has sound insulation, moisture-proof, heat insulation and cold-proof properties. Therefore, these characteristics far exceed the performance characteristics that other filling materials do not have.



# 22 | 22 MAJOR PRODUCT ADVANTAGES

## 18 COUNTERTOP 不锈钢喷砂纹台面

Our unique 1.2CM stainless steel solid countertop is industry-leading

It is truly fingerprint-free, scratch-resistant, acid-alkali-resistant, knock-resistant and aesthetically pleasing.





## 22 | 22 MAJOR PRODUCT ADVANTAGES

### 19 COUNTERTOP 不锈钢珠光纹台面



1. The front and rear beveled water stops can effectively prevent kitchen water from overflowing and causing unexpected losses.
2. MJ patented 304 food-grade stainless steel handmade sink is integrated with the stainless steel countertop without any gaps and will not breed bacteria.
3. The countertop and rear water barrier are integrated. The height of the rear water barrier can be adjusted to 20CM. L/U shapes and beveled corners can be made at will. Special craftsmanship.



# 22

22 MAJOR PRODUCT  
ADVANTAGES

## 20 COUNTERTOP 不锈钢磨砂纹台面

1. The thickness of the stainless steel countertop is up to 4.7CM, and the built-in filling honeycomb aluminum plate is more environmentally friendly and healthy.
2. The corners of the countertop are treated with R corners, which is beautiful and effectively prevents scratches and scratches.
3. The opening of the gas stove adopts an inverted R-angle opening on all four sides and is edged with stainless steel, which is more beautiful and has stronger load-bearing capacity.

Note: All countertop openings, edges and corners are free of charge





22 |

22 MAJOR PRODUCT  
ADVANTAGES

## 21 COUNTERTOP 不锈钢雨花纹台面



1. Countertop texture is more beautiful
2. The countertop texture is more resistant to scratches.
3. With fingerprint-free processing, cleaning is more convenient.

Note: The disadvantage of this countertop is that when building an L or U-shaped kitchen, a high or low countertop must be used.



**22** | 22 MAJOR PRODUCT  
ADVANTAGES

# INTEGRATED MOLDING OF TABLETOP

台面一体成型



# Kitchen Finishes and Design to Inspire



Panel design



Special texture



Wood texture



Solid colour



# L'Form

## Artistry in Design

As the heart is to the body, so is the kitchen to the home. The kitchen is increasingly becoming an important focal point, a centrepiece in most homes. An open concept layout that integrates a showcase kitchen with the living area has become an indulgence and object d'art for homeowners.

L'Form embodies this trend and takes inspiration from deconstructivism to reveal a seemingly complex yet elegant and subtle design. Its asymmetrical contours fused with an efficient layout create a central design sure to catch attention.

L'Form is meticulously hand-crafted by skilled artisans making each piece unique and one of a kind.





L'ARTISAN 96



PLAN VIEW

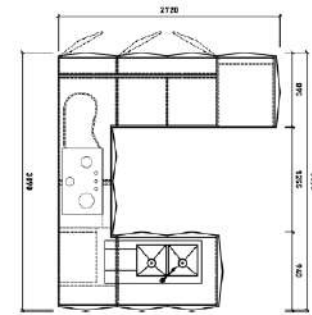

OVERALL DIMENSION

L 3090mm  
W 2720mm  
H 2180mm

SUGGESTED LAYOUT

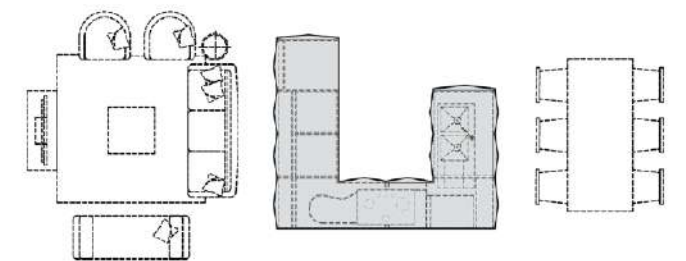



# L'Compact

## Fit and practical design solution

Living spaces in most cosmopolitan cities around the world are getting smaller. Space has become a most-coveted commodity.

L'Compact offers an ingenious solution for small living spaces. A compact and practical modular kitchen fitted with top of the line appliances and accessories.

L'Compact is ideal for smaller home or studio apartments. Folding doors and cabinetry in rich textures allow the homeowner to efficiently and artistically conceal the kitchen when it's not in use.

The collection also includes luxurious island towers with modular functional compartments that can be custom-fitted according to the user's needs.



L'ARTISAN 96





PLAN VIEW

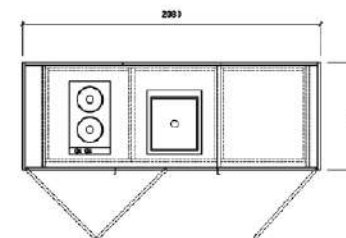

OVERALL DIMENSION

L 2080mm  
W 800mm  
H 2140mm

SUGGESTED LAYOUT

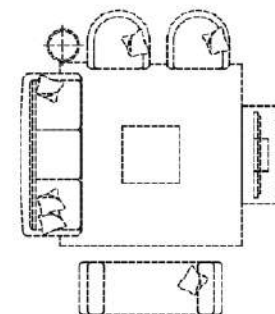
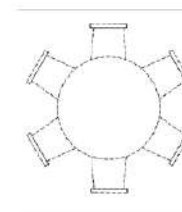



# L'Vie

## The Functional Lifestyle Design System

Food and culture are inextricably connected. Life is a culinary journey, a myriad of tastes and aroma that tantalizes the body and soul.

**Lifestyle** is a concept that brings the world of gastronomy and the love for the finer things in life in one integrated space. With a fully functional kitchen equipped with appliances and cabinetry on one side; a library style shelving and storage on the other. Lifestyle doubles as divider that seamlessly synthesizes the homeowner's culinary activities with the warmth of the living space.



L'ARTISAN 96





L'ARTISAN 96



PLAN VIEW

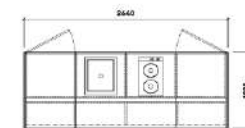

OVERALL DIMENSION

L 2640mm  
W 1030mm  
H 2100mm

SUGGESTED LAYOUT

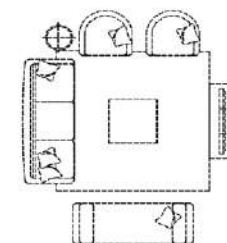
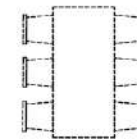





L'ARTISAN 96  
Stylish Stainless-steel Cabinetry

*Ideal kitchen and bathroom, L'Artisan 96 made with German craftsmanship,  
durable for 50 years*

DESIGN BY: THE P' CLUB GROUP



German DE technology,  
China CN manufacturing